

177' CREW/FSV KEITH G. McCALL



177' CREW/FSV KEITH G. McCALL

MAIN PARTICULARS

LENGTH OVERALL	54.00 m	177.00 ft
LENGTH BP	48.00 m	158.00 ft
BEAM	9.00 m	30.00 ft
DEPTH	4.00 m	14.00 ft
LIGHT DRAFT	2.00 m	5.00 ft
DRAFT LOADED	2.00 m	8.00 ft
SUMMER FREEBOARD	—	—
LIGHTSHIP	—	—

CAPACITIES

FUEL	100 m ³	26,500 USG
DRILL WATER	159 m ³	42,000 USG
POTABLE WATER	—	—
DRY BULK	—	—
BASE OIL	—	—
DEADWEIGHT	305 MT	300 LT

CARGO DECK

TONNAGE	229 MT.	225 LT.
STRENGTH	2 MT./m ²	LT./ft. ²
LENGTH	30 m	100 ft.
WIDTH	7 m	25 ft.
CLEAR AREA	213 m ²	2,290 ft. ²

TONNAGE

GRT	130 tons (ITC)	99 US tons
NRT	130 tons (ITC)	67 US tons

MACHINERY

MAIN ENGINES	4 x Cummins KTA50 M2	
BRAKE HORSEPOWER	7,200	
REDUCTION GEARS	4 x Twin Disc MG 6848	
GEAR RATIO	2.47:1	
RUDDERS	—	
PROPELLERS	—	
AUXILIARY GENERATORS	2 x Cummins 6BT5.9-G2	
BOW THRUSTER	1 x 200 hp Tunnel & 1 - 200 hp Azthumin	

PERFORMANCE

MAXIMUM SPEED	31 knots	
CRUISING SPEED	25 knots	
MAXIMUM FUEL CONSUMPTION	31 m ³ /24 Hrs	340 USG/Hr
CRUISING FUEL CONSUMPTION	27 m ³ /24 Hrs	294 USG/Hr

DISCHARGE RATES

FUEL	26 m ³ /Hr @ 70 m	115 USG/min @ 230 ft.
DRILL WATER	45 m ³ /Hr @ 61 m	200 USG/min @ 200 ft.
POTABLE WATER	—	—

ACCOMMODATIONS

CABINS/BERTHS	7/12
OFFICERS	2
CREW	5
VIP	6
PASSENGERS	82 Business Class
LOUNGE	—
MESS	7

ELECTRONICS & CONTROLS

DEPTH SOUNDER	Datamarine Digital 1
GMDSS	Yes
GPS	2 x Garmin 2006
RADAR(S)	2 x Furuno FR8111
VHF	4 x ICOM M502SSB
INTERNET E-MAIL	Globe Wireless
CSP MONITORING	—
WEATHER RADIO	—

SPECIAL EQUIPMENT

EXTERNAL FIFI	2 x SKUM 5300 GPM (FIF1)
NUMBER OF MONITORS	2
RIDE CONTROL	—

DOCUMENTATION

CLASS	ABS +1 HSC Crewboat +AMS +DPS-1
FLAG	United States
SOLAS	—
USCG	Subchapter T/L
YEAR BUILT	2003

This specification is preliminary and subject to change without notice. Exact tank capacities, deadweight, deck cargo capacity and other figures that have been calculated and may change when the actual vessel is delivered.

177' CREW/FSV KEITH G. McCALL

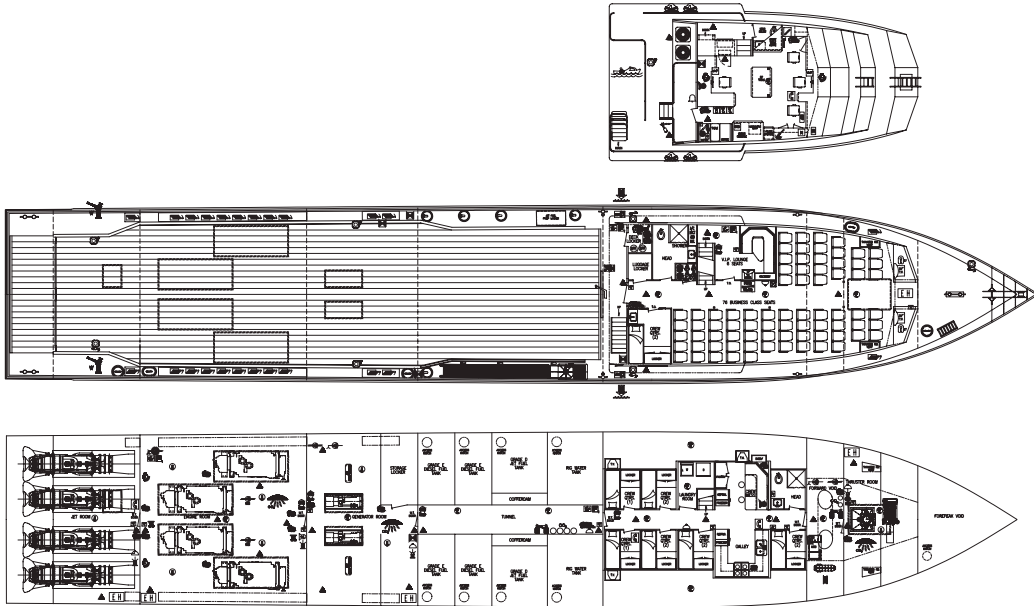

177' CREW/FSV KEITH G. McCALL